

BATTERED EDGE

BULLNOSE EDGE

ROUNDED EDGE

MANUFACTURED IN 36" LONG SECTIONS AND IS AVAILABLE IN THE FOLLOWING RADII: 12" HEIGHT: 5', 10', 15', 20', & 30' EXTERNAL RADIUS ONLY; BATTERED EDGE ONLY 18" HEIGHT: 3', 6', 8', 10', 15', 20', 30' EXTERNAL & 6', 15', 20', 30' INTERNAL RADIUS

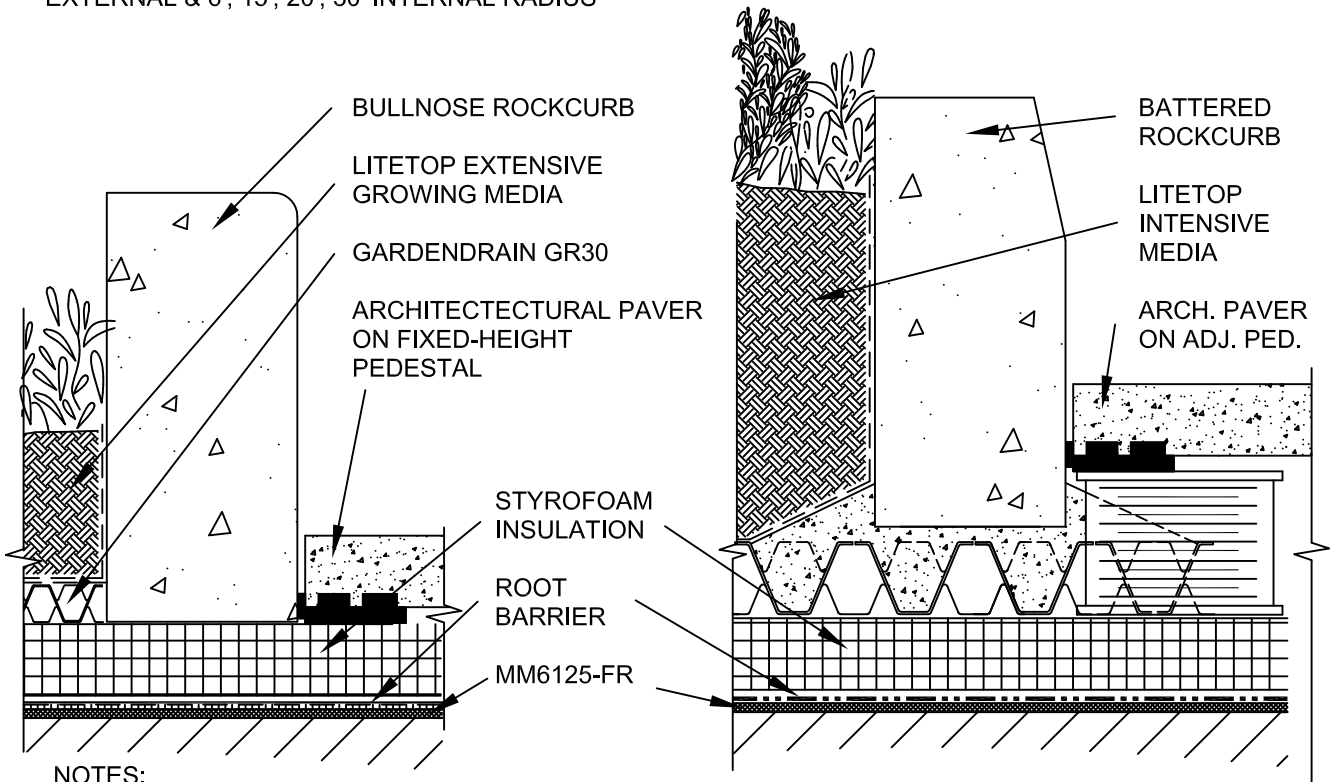

NOTES:

1. ROCKCURB IS AVAILABLE IN STANDARD HANOVER TUDOR FINISH AND COLORS.
2. ROCKCURB MAY REQUIRE STABILIZING AGAINST DIFFERENTIAL LOADING. i.e., PINNING END-T-END, MORTARING IN PLACE
3. REFER TO APPLICABLE MM6125-FR ROOFING OR WATERPROOFING GUIDELINE DETAILS FOR PROPER MEMBRANE/FLASHING DETAILS AND ALTERNATIVES AND GARDEN ROOF ASSEMBLY COMPONENT DETAILS AND ALTERNATIVES.



ULTIMATE ASSEMBLY

AMERICAN HYDROTECH, INC.

**ROCK CURB
STANDARD PRECAST**

SCALE: NONE DATE: 12/01/17	UA-6
-------------------------------	------

This information is intended only for general conceptual purposes. It is based on data and knowledge considered to be true and correct. It is offered for the user's consideration, investigation and verification and is not intended to substitute for the advice provided by appropriate professionals. Hydrotech assumes no liability for the use of this information. The determination of the suitability and applicability of this information is the sole responsibility of the user.